

Electric Door Operators and Panic Exit Device



8002 Electromechanical Door Operator	106
9000 Series Panic Exit Operators	108
DE6SC Delayed Egress Device	110

8002 Electromechanical Door Operator



General Information

The Lockwood Swing Door Operator is an electro-hydraulic operator designed for a wide variety of applications. It is suitable for almost all types of external and internal swing doors and has been developed to cope with tough conditions. The operator can be mounted on either side of the door for pull or push action and is suitable for single or double doors fitted with butt hinges or pivots. With remote, push button and motion sensor options, the 8002 provides a full range of electronic door opening solutions.

Features

- Opens with motor and closes with spring
- Opening and closing speeds can be varied individually
- Door opening angle adjustable up to 120°
- A range of manual and automatic activation units available
- Impulse and presence detection sensors available
- Non Handed
- Push or pull opening solutions

Applications

- Disability Entrance solutions
- Hospital and Health Centre Applications
- Access Controlled Locking
- In Swinging or Out Swinging Doors

Meets requirements for door weights/widths stated in the:

Controlled door closing, EN 1154 size 3 – 6

Coordination unit for rebated doors, EN 1158

Door closer with opening device (Swing door operator), DIN 18263-4 AU Size 3-6

ANSI/BHMA A156.10, A156.19



UL325/CUL325

SITAC 0710/97

8002 Electromechanical Door Operator

Pull Side

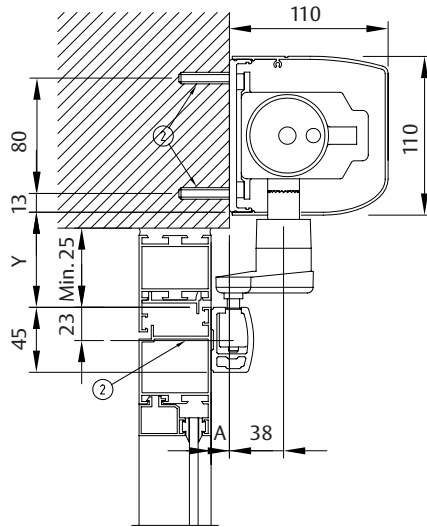

Push Side

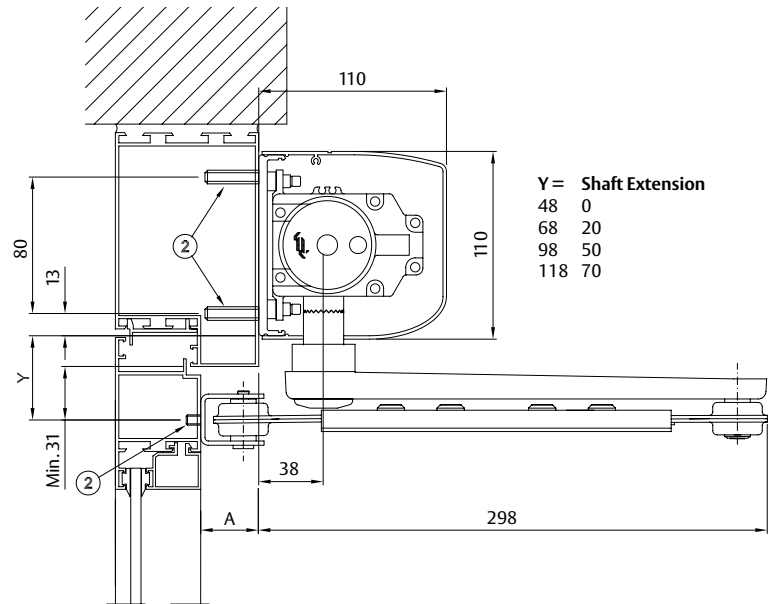

Technical Information

Electrical	230V AC Mains power, 50 Hz fuse 10 A
Door leaf width	Maximum door width – 1600mm
Recommended door weight	Maximum door weight – 250 kg
Door opening angle	Maximum opening angle - 120°
Closing Power	EN Size 3-6
Environment	Operational temperature range: -15°C to +50°C
Dimensions	110 (H) x 110 (D) x 716 (L) mm

Specification Statement

This Door Operator must have an electro-hydraulic motor with a capacity to push or pull doors up to 250kg in weight. The operator could be mounted on either side of the door for pull or push action and should be suitable for single or double doors fitted with butt hinges or pivots. The operator should have inputs for various electronic keypad controllers and motion sensors.

Ordering Information

Product Description	Part Number
Swing Door Operator (PUSH SIDE)	8002SSIL
Swing Door Operator (PUSH SIDE)	8002PSIL
Accessories	
Telescopic Arm 110 – 235MM Reveal (PUSH SIDE)	8002-173005
Telescopic Arm 235 – 360MM Reveal (PUSH SIDE)	8002-173004
Joint for Telescopic Arm 235 – 485MM Reveal (PUSH SIDE)	8002-173191
Doorstop – Push Arm System	8002-100147
Spacer For Door Fitting	8002-173804BK

9000 Series Panic Exit Device



General Information

This series of panic exit devices is designed to provide a ready means of escape at all times by the single action of pushing on a horizontal bar fitted across the full width of the door. Electromechanical push bars will ensure electronic locking of emergency exits.

A new safety concept which is both active and passive in order to satisfy requirements for property, security and life safety. Several versions including blocking, motorised holdback (Dogging) and monitoring functions ensure entrance and exit flow management.

Features

- Suitable for single and double door applications of 900 or 1200mm width doors
- All functions are reversible and non handed
- Deadlatching on all bolts
- Some models site adjustable
- Available in Horizontal or Vertical locking variations
- Standard maximum height up to 2300mm extension to 3000mm
- Safety clutch outside lever trim plate protects the unit from damage that could render the device inoperable
- Installed with centre line of exit device at 1023 mm above finished floor level

Applications

- Emergency escape exits
- Disability entrances

9000 Series Panic Exit Device

Technical Information

Voltage	The power supply must be regulated rectified DC voltage 24VDC or 48Vdc +/- 10%
Current	24Vdc +/- 10%, 145mA, 48Vdc +/- 10%, 73mA
Monitoring	Open/ Close Monitoring
Environment	Operational temperature range -20°C to + 60°C
Case/ Cover	Electroplated pressed steel
Latchbolts	Double chrome plated Steel
Door thickness	35-60 mm Standard
Cylinder	Special keyed options available
Security	Level S2 AS4145.2-1993
Durability	Level D3 AS4145.2-1993
Furniture	9000/10SIL Lever Plate, 9000/15SIL, 9000/20SIL
Finishes	Body –Silver Powdercoat, Touchbar – Red Powdercoat

Standards and Compliance



Electromagnetic compatibility to European CE compliance, the equivalent of C-Tick compliance.



Successfully fire rated up to 4hrs on fire door assemblies in accordance with AS1905.1. 2005 (Part 1: Fire resistant door sets).

S2

Level S2 (Physical Security) AS4145.2-1993.

Level D3 (Durability) AS4145.2-1993.

AS2331-3.1 – 2001. Neutral Salt Spray Test (NSS TEST).

Conforms to Australian BCA D2-21 (d) for egress doors

Ordering Information

Product Description

EHorizontal Single Point Locking, 900mm 24v

Horizontal Single Point Locking, 1200mm 24v

Horizontal Single Point Locking, 24v

Vertical 2 point locking, 900mm 24v

Vertical 2 point locking, 1200mm 24v

Vertical 2 point locking, 24v

Accessories

Lever on Plate

Cylinder Pull Plate

Plain Pull Plate

Part Number

9000EO/24BSIL

9100EO/24BSIL

9700EO/24BDMSIL

9300EO/24BSIL

9400EO/24BSIL

9800EO/24BDMSIL

9000/10SIL

9000/15SIL

9000/20SIL



ASSA ABLOY

DE6SC Delayed Egress device

General Description

The DE6SC is designed to alert a user if an unauthorised attempt is made to access a door, particularly when free egress is required. The unit emits an infrared beam down towards a panic bar or lever. A small piece of reflective tape is placed on either of these two devices and when an attempt is made to push the panic bar or lever, the DE6SC will trigger an alarm. After 15 seconds the DE6SC releases the electronic locking mechanism thereby unlocking the door. The alarm continues to sound giving someone the opportunity to investigate the security breach. The unit is reset by disconnecting the power, this can be achieved through a keyswitch or access control panel. The delayed exit operation of the DE6SC will be overridden in the event of a fire alarm or duress. The ability to override the delay is what makes the DE6SC suitable for the locking of fire door or general emergency exits.

Key Features

- Slave lock input for double doors
- Fail safe push to exit input
- Alarm output connected directly to siren
- Remote monitor alarm output
- Lock Monitoring
- Door Monitoring

Applications

- Fire exit doors for retail or commercial environments



Standards and Compliance

CE CE Approved

C-Tick Certified

Successfully fire rated up to 2hrs on fire door assemblies in accordance with AS1905.1. 2005 (Part 1: Fire resistant door sets)

Locking Mechanism (ES6000) conforms with the relevant requirements in accordance to AS4145.2

Conforms to D2.21 of the BCA (Building Code of Australia)

DE6SC Delayed Egress device

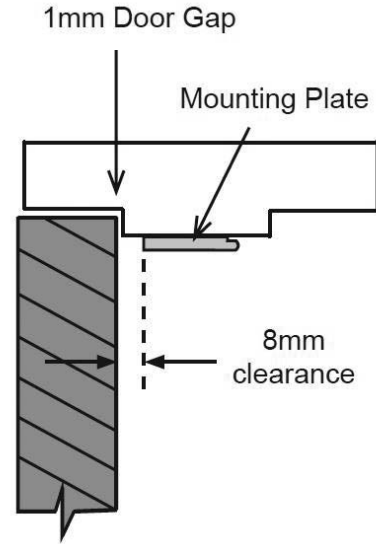
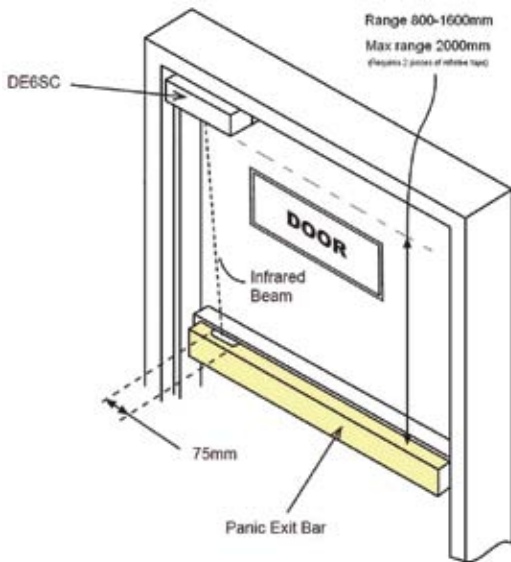

View from Top of Door

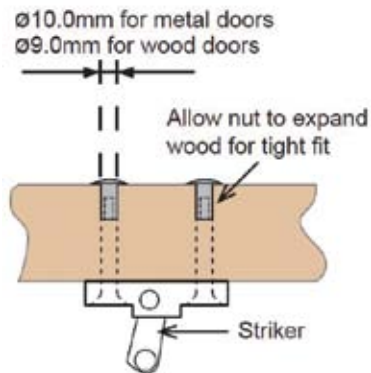
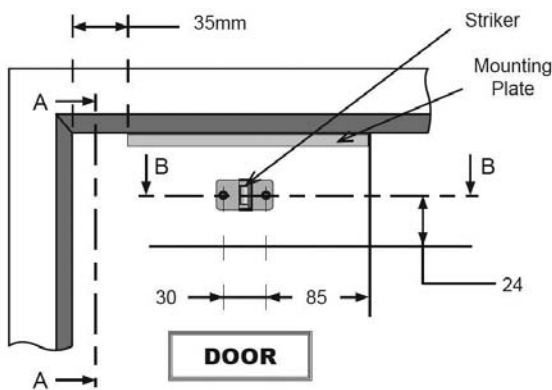

DE6SC Technical Information

Voltage	12v AC or DC
Current	12Vdc -375ma after 1 second (830ma Initial draw)
Monitoring	Lock and Door monitoring
Holding Force	1500lbs 680kg
Pre-load	660lbs 300kg
Environment Operational	Temperature range -20 deg - +60 deg

Ordering Information

Product Description	Part Number
DE6SC Delayed Egress Hook Lock	100610-050
DE6SC Reflective Tape	220600-507

Specification Statement

The Delayed Egress System must be "Deemed to satisfy" the relevant sections of the Building Code of Australia. The system should be capable of integration with the building fire system where activation of the fire system will directly and immediately release the lock. An audible alarm should indicate to a person wishing to exit that a delay before door release is active and a distinctive change of this audible alarm would indicate the door is available for immediate exit. The delaying circuits should also be suitable for instant by-pass if an emergency pushbutton is fitted adjacent to the door. Full monitoring of lock status and door position should be available from within the system. Resetting of a released door should be by a local key re-set or remotely re-settable depending on site requirements.